

XL pull-out unit for 2,700 mm beams 1,200 kgs load capacity| 100 % pull-out

XL pull-out units can be integrated into existing pallet racks. They are placed on the cross beams and bolted in the rear area. Loading can be done from the forklift corridor as well as from the picking corridor. The pull-out unit is delivered unasssembled. A fastening set is included in the scope of delivery.

Product details

Load capacity	1,200 kgs (evenly loaded)
Pull-out depth	100 %
Material	Steel
Empty weight	145 kgs
Suitable for rack depth	970 - 1,170 mm
Configuration	Turnable round bar for locking

Commodity code	73089098
Packaging unit	1 piece
Max. Quantity / pallet	2 pieces

Versions

Dimension (WxDxH)	Colour	Art-No.
2,630 x 1,235 x 122 mm	RAL 5010	412102600
2,630 x 1,235 x 122 mm	RAL 7024	412102600

Please specify a colour when ordering.



Fully extended pull-out unit



Closed pull-out unit

LOAD	PULL-OUT	COLOUR	COLOUR	MAX. QUANTITY/ PALLET
1,200	100	5010	7024	2

XL pull-out unit for 2,700 mm beams 1,200 kgs load capacity| 100 % pull-out

Engineering drawing

A

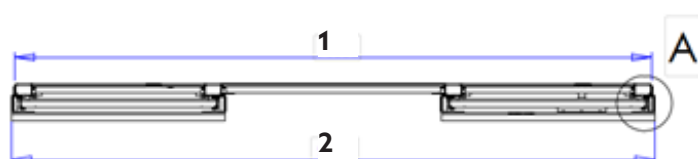

B

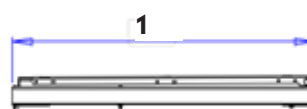

D



C

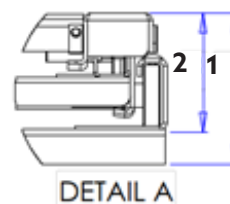
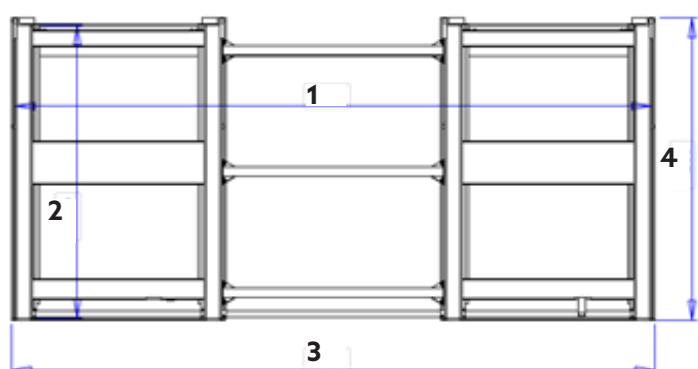

Dimensions

Number	Size in mm
A 1	2,600 mm
A 2	2,630 mm
B 1	1,235 mm
C 1	2,600 mm
C 2	1,200 mm
C 3	2,630 mm
C 4	1,235 mm
D 1	1,200 mm
D 2	1,204 mm
Detail A 1	154 mm
Detail A 2	122 mm

Mounting kit

Screws	Beams
M10 x 140	For beam height up to 110 mm
Screws for other beam height on request!	

XL pull-out unit for 2,700 mm beams

1,200 kgs load capacity| 100 % pull-out

Important safety instructions

- The pallet rack must be securely anchored to the floor. Please follow the assembly and safety instructions of the rack manufacturer
- Beams must be firmly bolted to the support uprights (using at least M8 bolts)
- Pull-out units must be fixed using the bolts, nuts, washers and counterplates supplied according to the assembly instructions
- Depending on the different pull-out units and the length of the beams, the rack must have a minimum shelf load according to the table below
- The maximum load capacity of the pull-out units with an evenly distributed load and safety instructions are attached to the pull-out units
- If there are several levels with pull-out units, only one unit may be extended at a time
- Immediately after using the pull-out unit, it must be pushed back again and it must be ensured that it is locked in place

Necessary shelf load of the beams

L = 2,700 mm 1 pull-out unit
3,999 kgs

Data sheet, status 04.2025
Errors and omissions excepted. All values are approximate. Pictures
may show accessories or other products.